

SUNSEEKER PREDATOR 72





Aspire
of London

Comfort & Sport

The Predator 72 is a strong and comfortable yacht with a beautiful and winning line. Fast and noiseless, she permits to sail safe and pleasantly in every condition. The spacious saloon with his big hardtop and the wide exterior spaces assure an agreeable navigation to 12 guests. Her equipment is complete and at top level, from the satellite dish, to the submersible beach platform, to the jet tender.















The well-appointed and cosy lower accommodations with the exclusive full-beam master suite, the vip suite on the bow and the two further cabins, provide the good quality of life on board to 6/8 people cruising.



The bathrooms are elegant and well designed and the equipment complete and at top level.

Technical Details

Length overall (incl. Pulpit): 73 ft

Length overall (excl. Pulpit): 72 ft

Beam: 17,7 ft

Draft: 5 ft 5 in

Displacement approx.: 91.712 lbs

Fuel capacity: 1.030 US gal

Water capacity: 198 US gal

Engines: 2 1360 hp diesel Man

Generators: 1 KOHLER 17 Kw

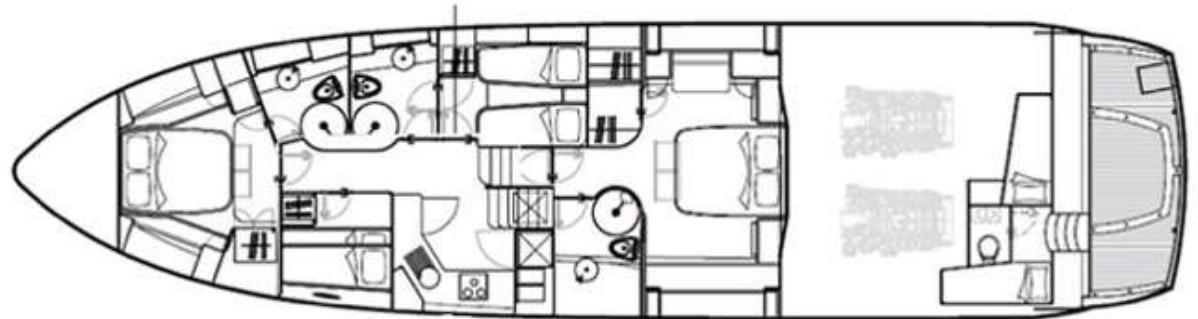
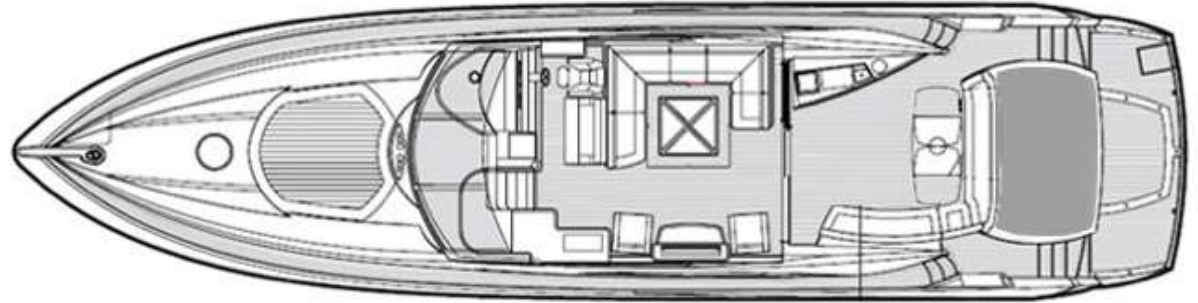

Maximum speed: 35 knots

Cruising speed: 23 knots

Fuel consumptions:

Cruising speed 310 lt/hr;

Maximum speed 500lt/hr;

Range: 350 nm (cruising speed).

Accommodations: guests 8 in 4 cabins; crew 2 in 1 cabin